

Three  
bedroom  
home.

# The Copenhagen

The Copenhagen is a three-bedroom home which is ideal for both couples and families. The ground floor features a dual aspect kitchen and dining space to one side, and a living room with French doors to the other. There is also a downstairs W.C. To the first floor, there is a master bedroom and two further well proportioned bedrooms. The family bathroom completes the first floor. Externally there is private parking and a rear garden.



**karbon**  
living

Homes for you to rent or buy.

For more information, please contact us at:

**[salesandlettings@karbonhomes.co.uk](mailto:salesandlettings@karbonhomes.co.uk)** | **0191 223 8749**

or visit **[karbonhomes.co.uk](https://www.karbonhomes.co.uk)**

Images for illustration purposes only. Room sizes included have been measured from architect's plans and any furniture added is intended to give a general indication of the proposed floor layout only and does not form any part of contract. PV roof panels not shown on illustration.

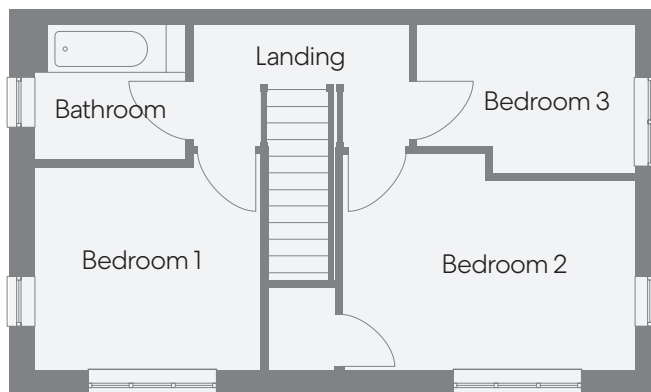
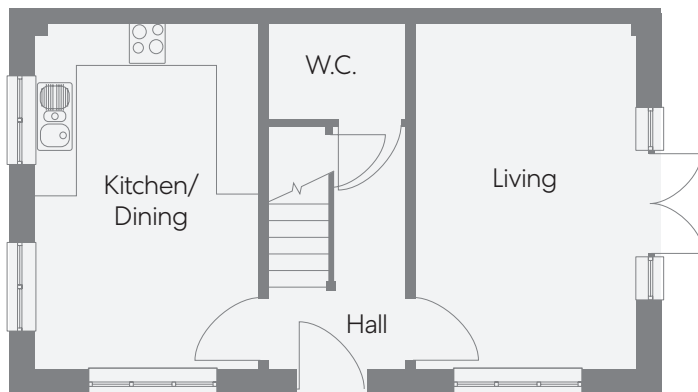

#### Ground Floor

##### Living

16' 2" x 10' 3"

##### Kitchen Dining

16' 2" x 16' 2"

##### W.C.

6' 5" x 4' 6"

#### First Floor

##### Bedroom 1

10' 7" x 9' 6"

##### Bedroom 2

13' 7" x 10' 2"

##### Bedroom 3

10' 2" x 6' 11"

##### Bathroom

7' 1" x 6' 4"

# karbon living

Homes for you to rent or buy.

For more information, please contact us at:

**salesandlettings@karbonhomes.co.uk** | **0191 223 8749**

or visit **karbonhomes.co.uk**