

Two
bedroom
home.

The Portland

The Portland is a two-bedroom home which benefits from a welcoming entrance hall leading to a modern kitchen to the front of the home, as well as a downstairs W.C. There is a spacious living room to the rear with French doors. To the first floor, there is a spacious master bedroom, as well as a second bedroom and a family bathroom. Externally there is private parking and a rear garden.



karbon
living

Homes for you to rent or buy.

For more information, please contact us at:

salesandlettings@karbonhomes.co.uk | 0191 223 8749

or visit **[karbonhomes.co.uk](https://www.karbonhomes.co.uk)**

Images for illustration purposes only. Room sizes included have been measured from architect's plans and any furniture added is intended to give a general indication of the proposed floor layout only and does not form any part of contract. PV roof panels not shown on illustration.

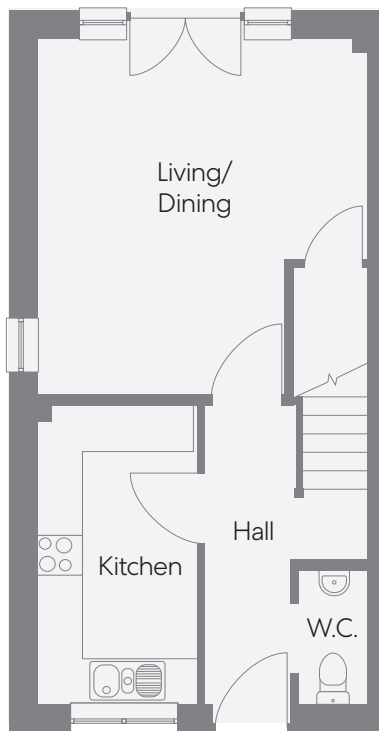

Ground Floor

Living/Dining

13' 11" x 14' 11"

Kitchen

12' 7" x 6' 9"

W.C.

5' 7" x 2' 11"

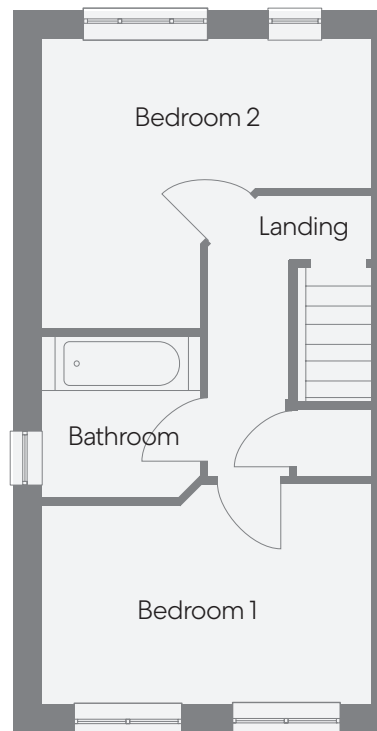

First Floor

Bedroom 1

13' 11" x 9' 3"

Bedroom 2

13' 11" x 12' 2"

Bathroom

6' 10" x 6' 9"

karbon living

Homes for you to rent or buy.

For more information, please contact us at:

salesandlettings@karbonhomes.co.uk | **0191 223 8749**

or visit **karbonhomes.co.uk**